

COLUMNA 8m / 8m COLUMN			
Peso / Weight		215 Kg	
Material / Material	Altura / Height	Acabado / Finish	Sección / Section
S-355 MC	8.20 m	Galvanizado	△212 x 3,5mm
GRUPO OPTICO / OPTICAL GROUP			
Cable Tipo / Cable Type : H05VV-F 3 x 2,5 mm ²			
Potencia / Power		150W	
Portalamparas / Lamp holder		E40	

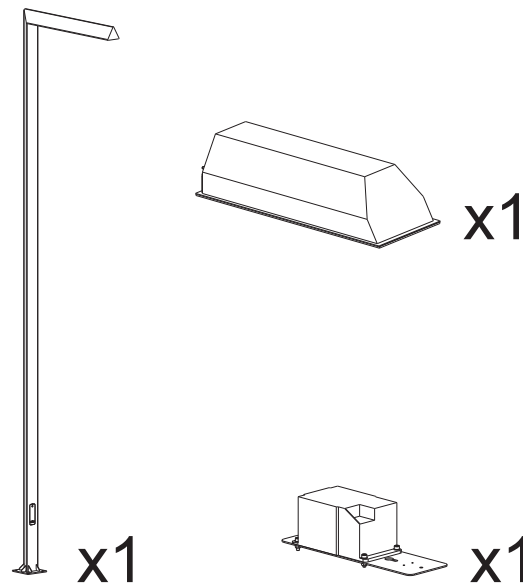

SUMINISTRO SUPPLY LIST



INSTRUCCIONES DE SEGURIDAD

Luminaria para exterior.

Las conexiones eléctricas deben realizarse por personal especializado.

Antes de empezar las operaciones de montaje:

Deje sin tensión eléctrica la red.

Utilice siempre la lámpara recomendada.

Antes de sustituir la lámpara, asegúrese de desconectar la luminaria de la red, y esperar que esté fría al tacto.

El fabricante no se hace responsable del uso indebido de la luminaria.

SAFETY INSTRUCTIONS

The lamp is for outdoor use only.

The lamp must be installed by a specialist.

Before connecting the lamp:

Be sure that there is no voltage in the feeding conductors coming from electrical mains.

Remove the fuse or switch off the main switch.

Always use the recommended bulb.

Before replacing the bulb, switch off the main electrical switch and wait until the bulb has cooled down.

The manufacturer declines all responsibility for misuse of the lamp.

SANTA & COLE

Balta
Patxi Mangado

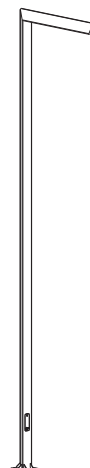

INSTRUCCIONES DE MONTAJE ASSEMBLY INSTRUCTIONS

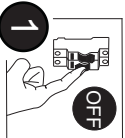

2

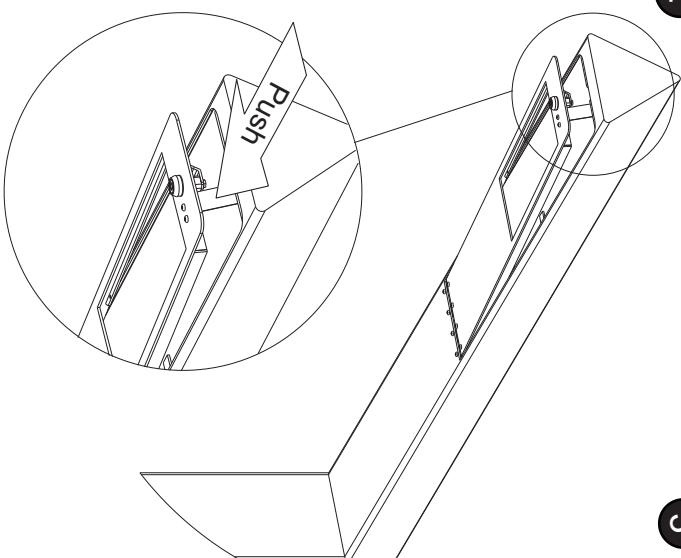

3

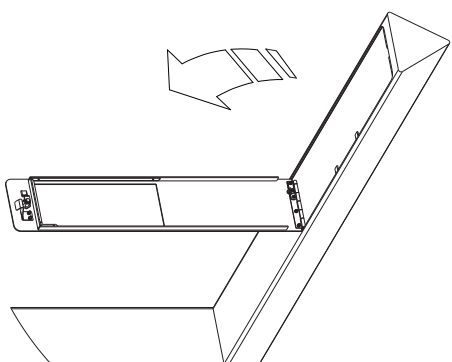

4

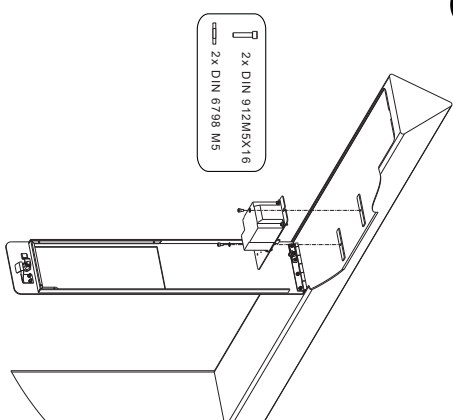

5

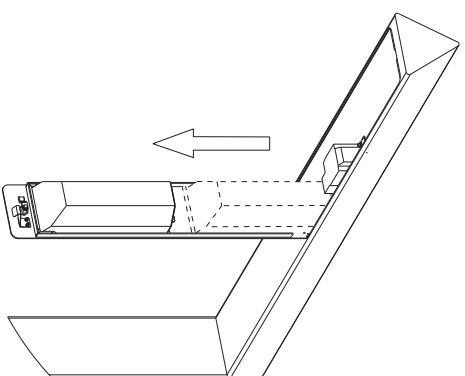

6

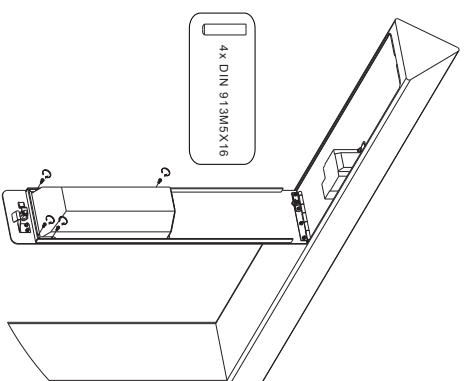

7

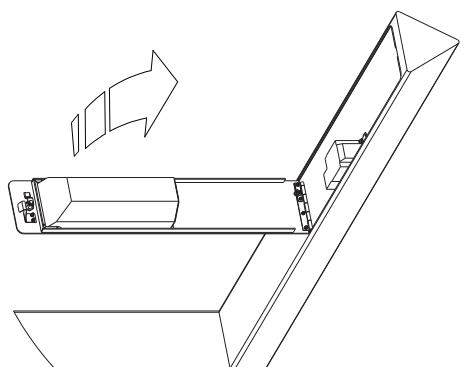

8

