

SANTA & COLE

## LAMPARAALTA

diseño/design by  
Beth Galí - Màrius Quintana  
1983

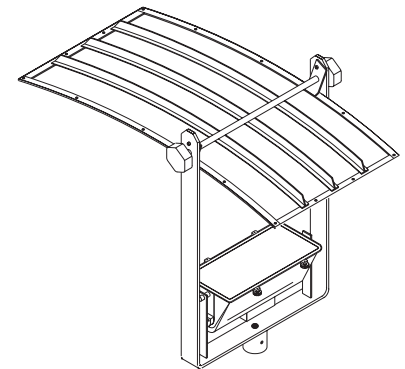

instrucciones de montaje  
*assembly instructions*

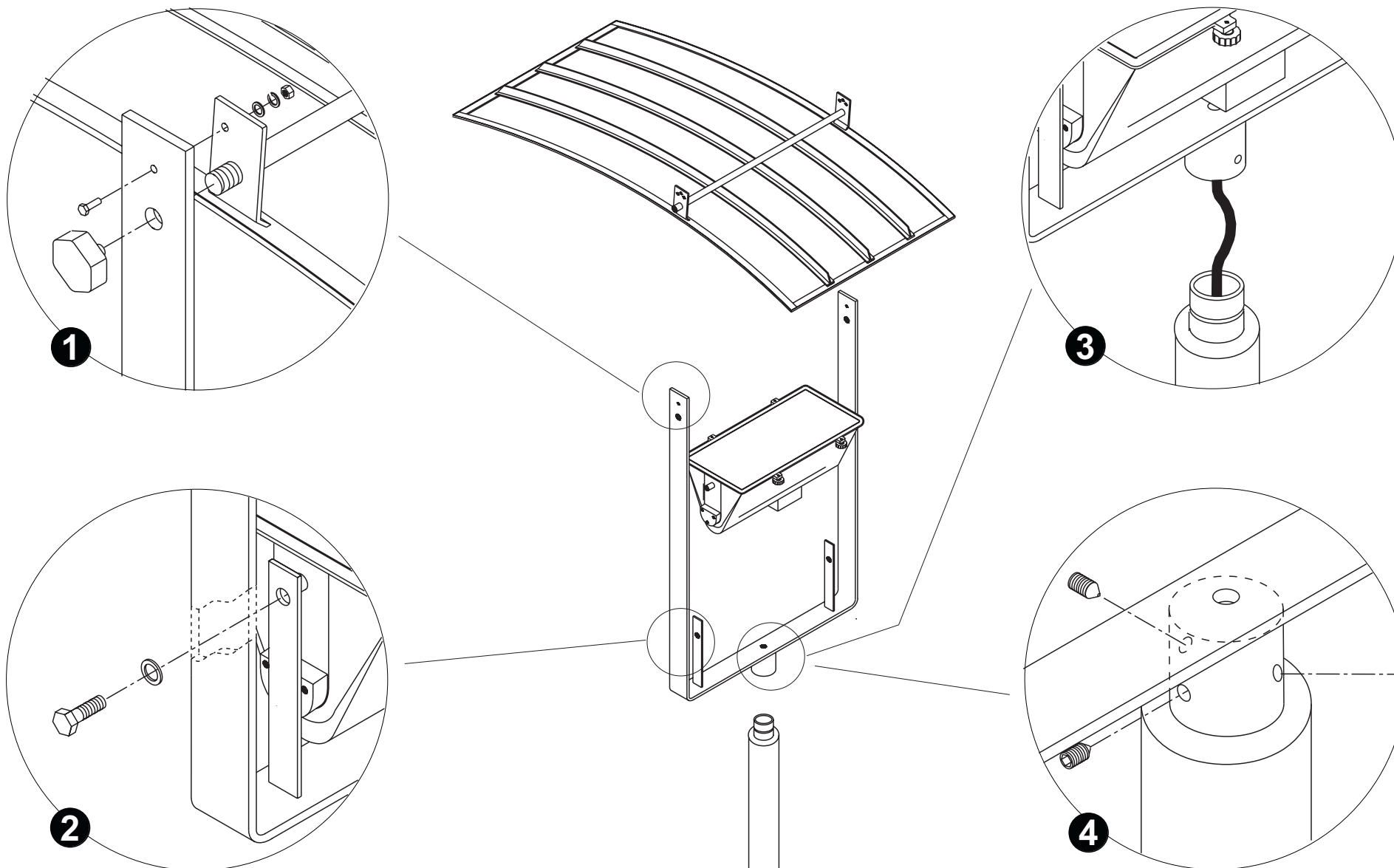

En zonas de alta exposicion a vientos fuertes y/o variables, se recomienda el uso de fijador de tuercas (Loctite 2701 threadlocker)  
*In high or variable winds exposition areas, is recommended the use of nut fixer (Loctite 2701 threadlocker)*